

STAINLESS STEEL 304 PRESS FIT FITTINGS (M PROFILE)

COMPLY WITH BSEN1254-2: 1998



A Product of the nPressGuard® Solution



LONG SOCKET

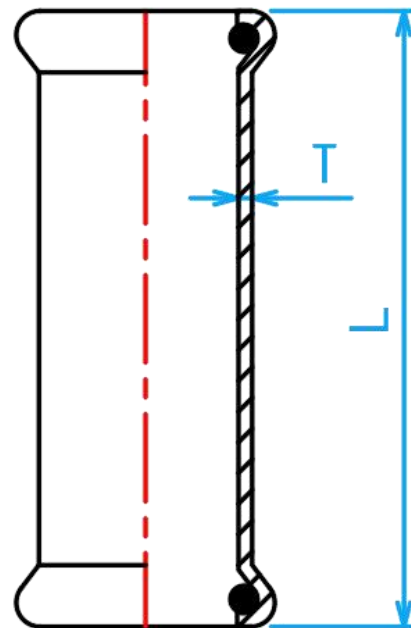

CROSS SECTIONAL VIEW

DIMENSIONS

| SKU | SIZE (mm) | L (mm) | T (mm) | WEIGHT (kg) | PCS/CTN |
|-------------|-----------|--------|--------|-------------|---------|
| SSPFNES015L | 15 | 80 | 1.5 | 0.053 | 250 |
| SSPFNES020L | 22 | 85 | 1.5 | 0.086 | 120 |
| SSPFNES025L | 28 | 95 | 1.5 | 0.120 | 100 |
| SSPFNES035L | 35 | 105 | 1.5 | 0.150 | 60 |
| SSPFNES042L | 42 | 120 | 1.5 | 0.250 | 70 |
| SSPFNES050L | 54 | 135 | 1.5 | 0.290 | 40 |
| SSPFNES065L | 67 | 200 | 1.8 | 0.690 | 20 |
| SSPFNES080L | 76 | 225 | 2.0 | 0.900 | 15 |
| SSPFNES100L | 108 | 315 | 2.0 | 1.860 | 4 |